

SITE / STILT / GROUND FLOOR (PART) PLAN

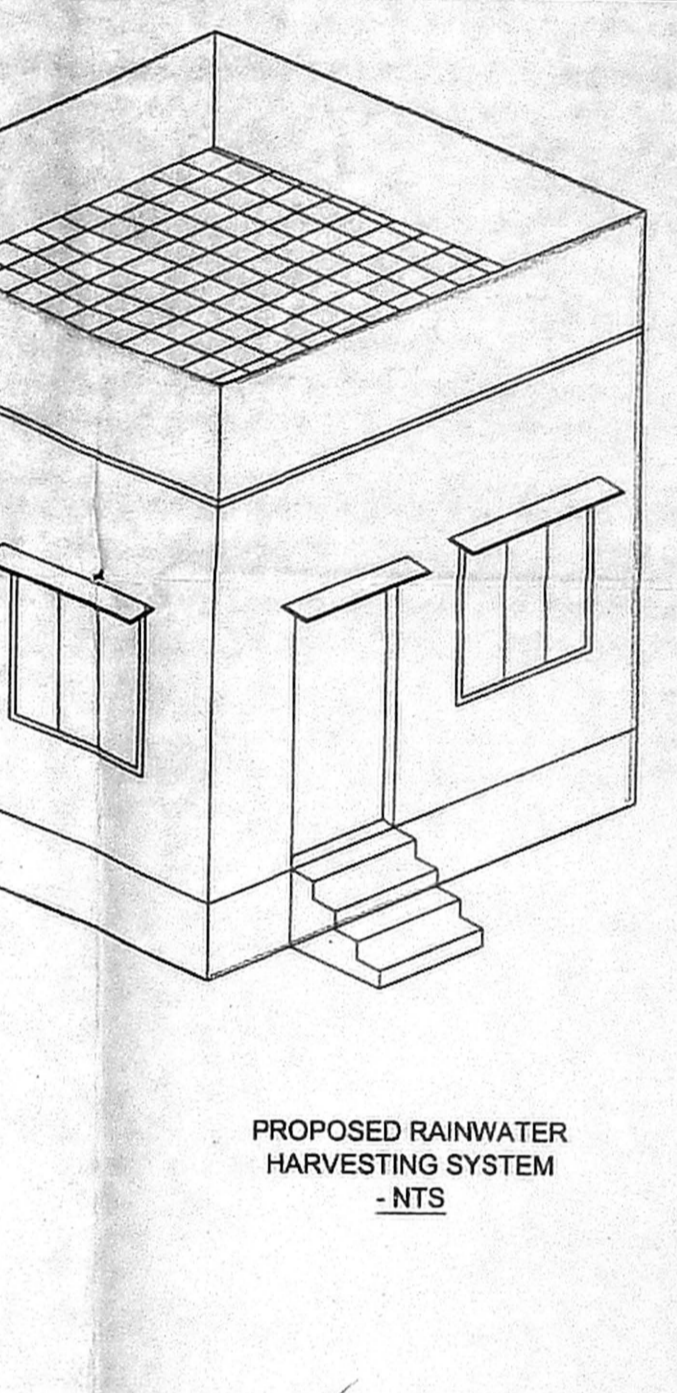

RAINWATER HARVESTING DETAIL - 3A

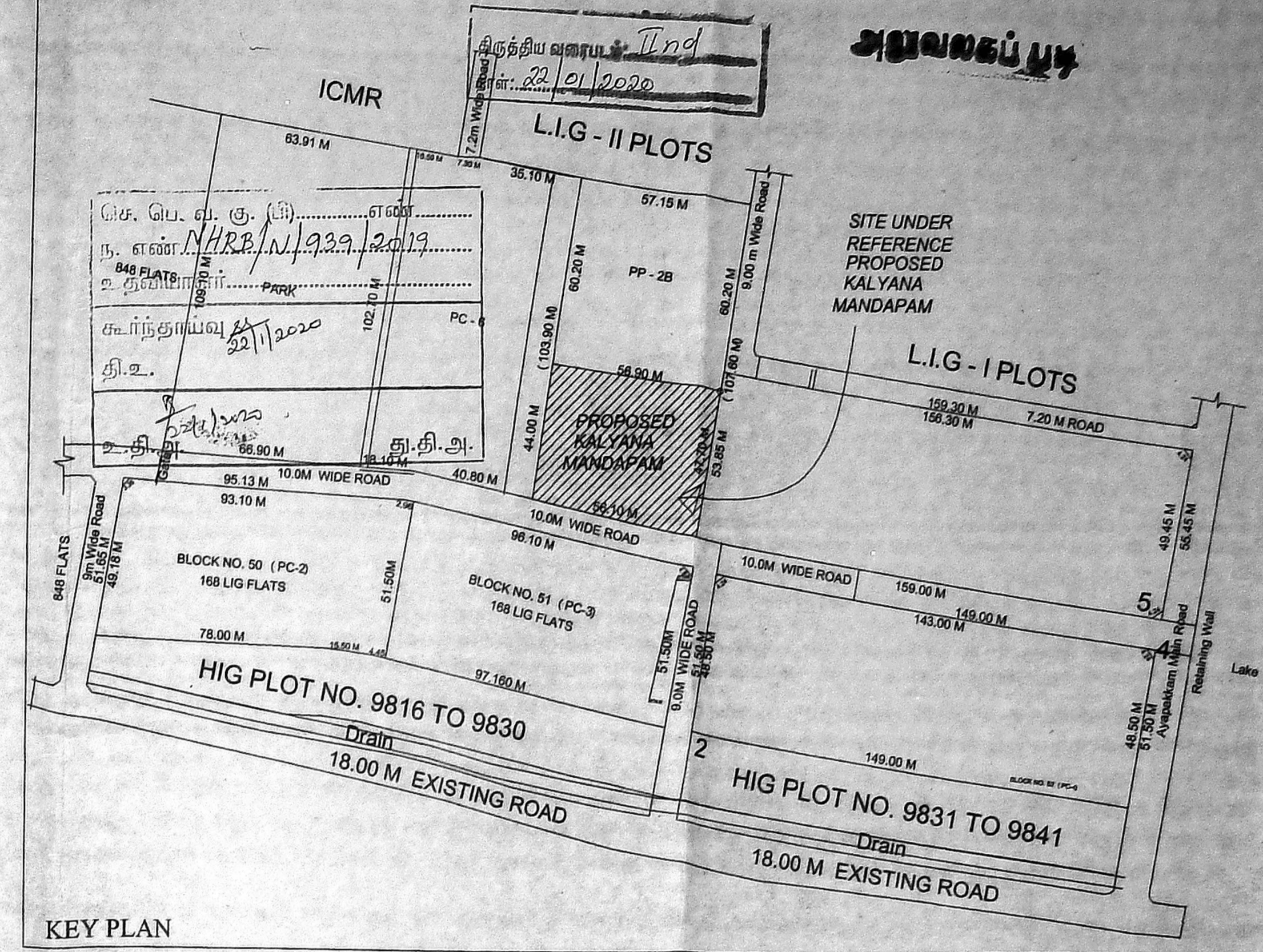
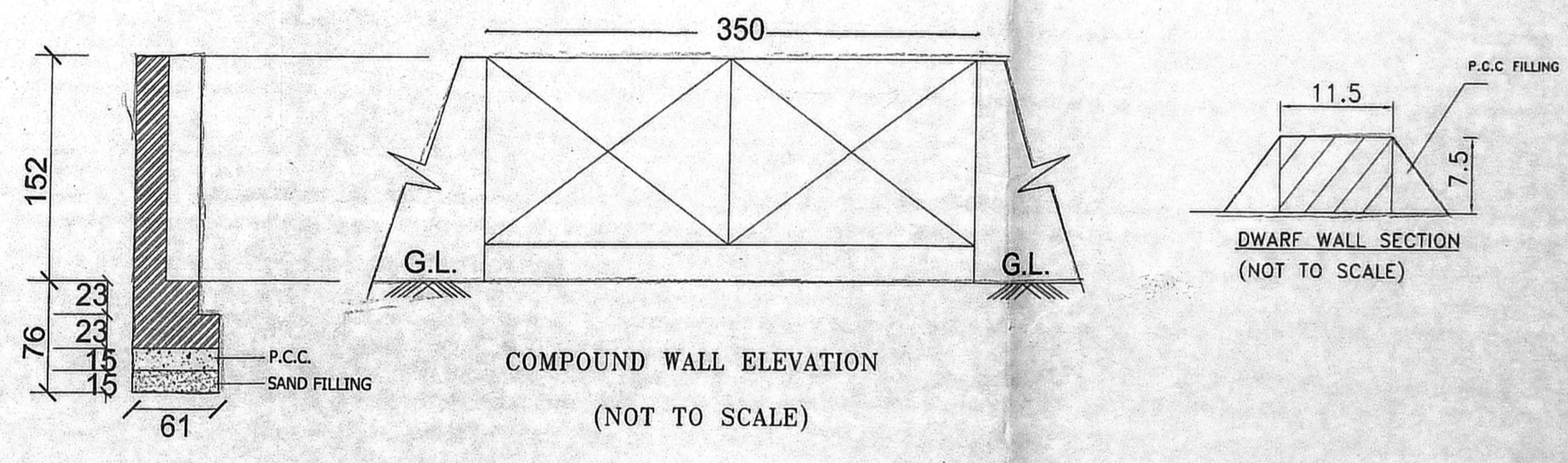

COMPOUND WALL ELEVATION (NOT TO SCALE)

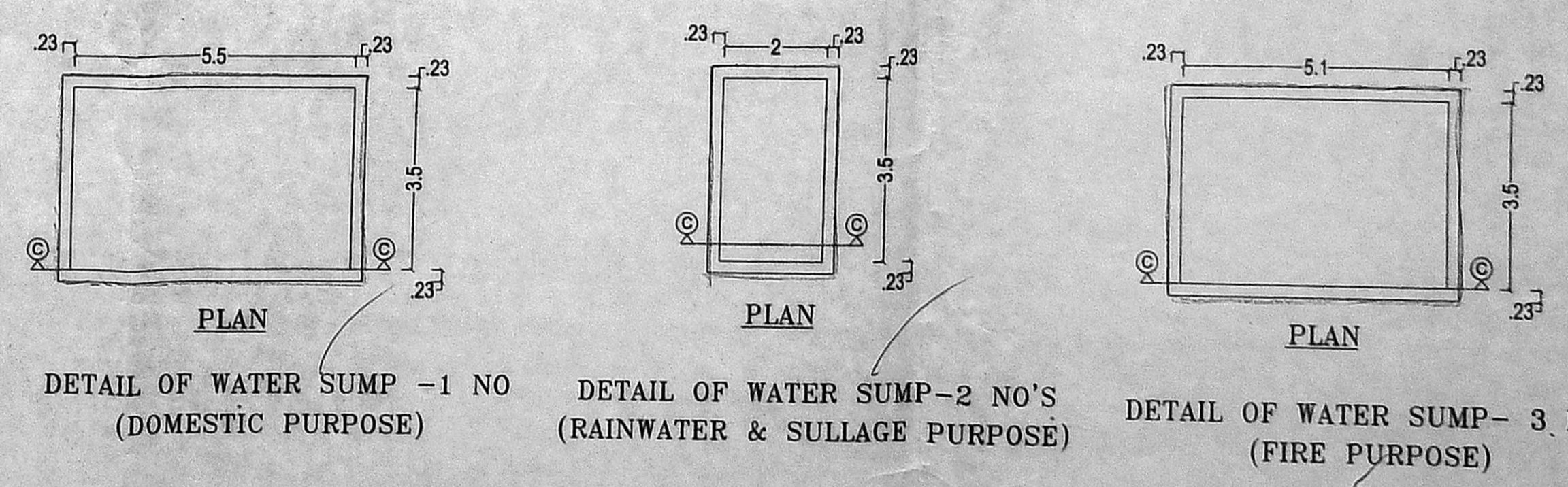
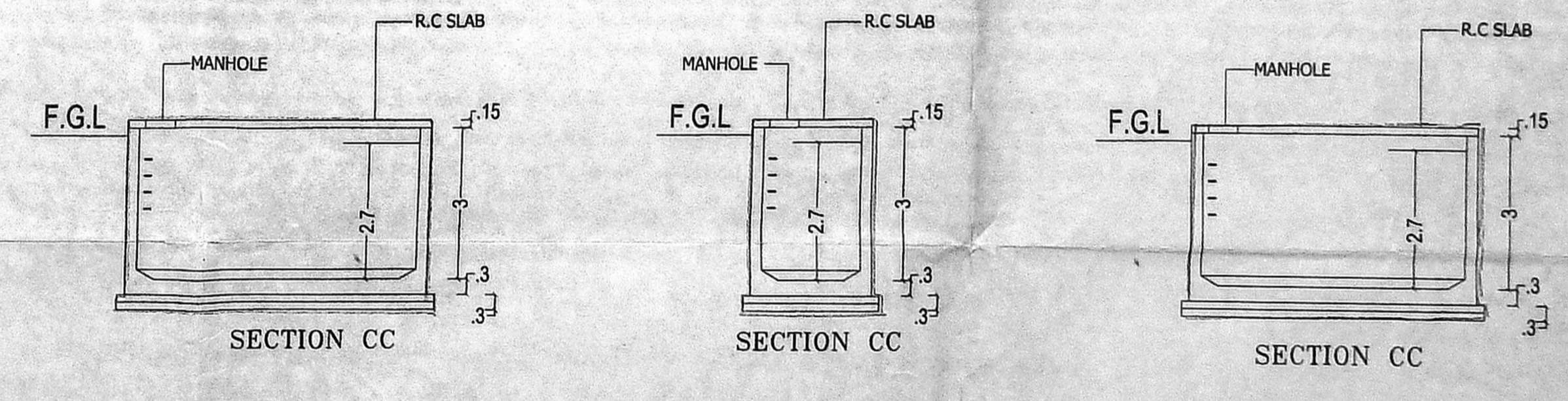

DETAIL OF WATER SUMP - 1 NO (DOMESTIC PURPOSE) DETAIL OF WATER SUMP - 2 NO'S (RAINWATER & SULLAGE PURPOSE) DETAIL OF WATER SUMP - 3 NO'S (FIRE PURPOSE)

AREA DETAILS		PLINTH AREA
(L2 / 5253 / 2018) Dt - 04/07/2019		
SUB DIVISION OF PP PLOT 2 IN 2 PLOTS PP 2A		
PLOT EXTENT AS PER SUB DIVISION	2587.73 Sqm	
GROUND FLOOR PART	39.46 Sqm	
FIRST FLOOR	1036.22 Sqm	
SECOND FLOOR	1036.22 Sqm	
THIRD FLOOR PART	313.86 Sqm	
TOTAL	2425.76 Sqm	
TOTAL PLINTH AREA	= 2425.76 Sqm	
F.S.I	$\frac{2425.76 \text{ Sqm}}{2587.73 \text{ Sqm}} = 0.94$	

STILT FLOOR PLAN	
NO.OF CAR PARKING PROVIDED	= 49 NOS
NO.OF TWO WHEELER PARKING PROVIDED	= 67 NOS

STRUCTURAL ENGINEER:
P.K. CHANDRAN S.E. (E.S. 1802)
 STRUCTURAL ENGINEER
 No. 187, MALLANNA STREET
 ROYAPETTAH, CHENNAI-600 014

ARCHITECT:-
R. dx Architecture | Interior Design | Landscape Design
 #5/4, 2nd Main Road, CIT Nagar, Chennai-35
 E-Mail: architects@rdxgroup.in
 Ph: 044-42647209

COLOUR INDEX		1 / 2
	BOUNDARY	
	PROPOSED	
	ROAD	

TAMIL NADU HOUSING BOARD	
CONSTRUCTION OF STILT PART / GROUND FLOOR PART + 2 FLOORS + 3 FLOOR PART KALYANA MANDAPAM AT SUB DIVISIONAL PP PLOT No.2A IN PPD / LO No. TNHB G/3 2019 KALYANA MANDAPAM COMPRISED IN S.No. 582 / 2 PART OF AMBATHUR VILLAGE, AMBATHUR TALUK, THIRUVALLUR DISTRICT.	
(AMBATHUR PHASE 1 & 2 SITE & SERVICE SCHEME)	
JJ NAGAR DIVISION	SCALE : 1:200
SD/-XXXX DT: 12.9.17 SURVEYOR	SD/-XXXX DT: 12.9.17 HEAD SURVEYOR
SD/-S.KARTHICK DT: 12.9.17 JUNIOR ENGINEER	SD/-R.CHITRI POKKI DT: 12.9.17 ASST. ARCHITECT
SD/-M.RAJASEKAR DT: 12.9.17 TOWN PLANNER	SD/-ANAVANEETHAN KANNAN DT: 12.9.17 SUPTDG.ENGINEER (HQ)

Executive Engineer & Admin Officer
 Tamil Nadu Housing Board,
 JJ Nagar Division,
 Thirumangalam, Chennai-600 701

